

Gas Protection



Building Protection Systems

Turnkey Solutions - from Site Investigation to Validation



SEL offer the reassurance of a single point of contact to all parties involved in the design, supply, installation and validation of a complete gas protection system.

All solutions will be CIRIA, NHBC & Building Regulations compliant with supporting calculations and CAD details with particular consideration of system performance, constructability, risk assessment and architectural aesthetics with access to a range of vent outlets developed to satisfy the requirements of Client and Architect.



SEL can provide advice and guidance with regard to carrying out a robust site investigation including gas monitoring. We can then review these reports and advise on options for compliance to current guidance and legislation.

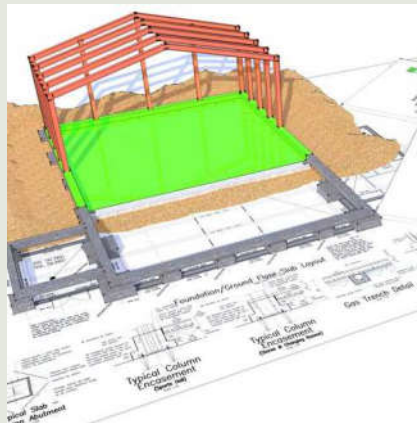

Full ground gas protection system design available for buildings, external areas and perimeter protection. All solutions will be CIRIA, NHBC & Building Regulations compliant with calculations and CAD details.



SEL are a specialist installer with over 20 years experience in this field, qualified to NVQ Level 2 in Gas Membrane Installation as recommended in CIRIA C735. All SEL installers hold CSCS cards.

We can coordinate independent 3rd party validation ensuring your project complies with the relevant building regulations. You will receive a full validation report for submission to the Local Authority to show compliance.



SEL can provide complete Ground Gas Protection Systems in accordance with Ciria C655, Ciria C735, NHBC traffic lights and current building regulations.

We offer different gas barrier membrane systems such as carbon dioxide barrier, methane barrier, radon barrier or VOC hydrocarbon barriers. We are a recognised installer of Cordek ventform, Juta membrane, Protech membrane and Visqueen membrane.

We have a standard range of ground level vent, vent bollard and vent stack or can manufacture bespoke vents to suit Client architectural requirements.

If required we can assist with the arrangement of third party gas monitoring or third party gas validation report.





SEL have good close working relationships with many of the recognised key suppliers in the gas protection market such as Proctor Group, Juta, Visqueen and Cordek. These relationships offers an unrivaled expertise to ensure correct product specification, application and installation.

With over 20 years of experience of installing passive and active gas protection systems, SEL have the knowledge and experience to deliver a quality assured, trouble free installation.





Canal House, Bonsall Street, Blackburn, BB2 4DD
T: 01254 589987 E: info@selenvironmental.com W: www.sel.co.uk